

REV.	DESCRIPTION	DRAWN	ECN	DATE
A	NEW RELEASE (3005-10073)	TINA	10-423	12-23'2010
B	SEE ECN (3007-11004)	KEN	11-004	01-05'2011

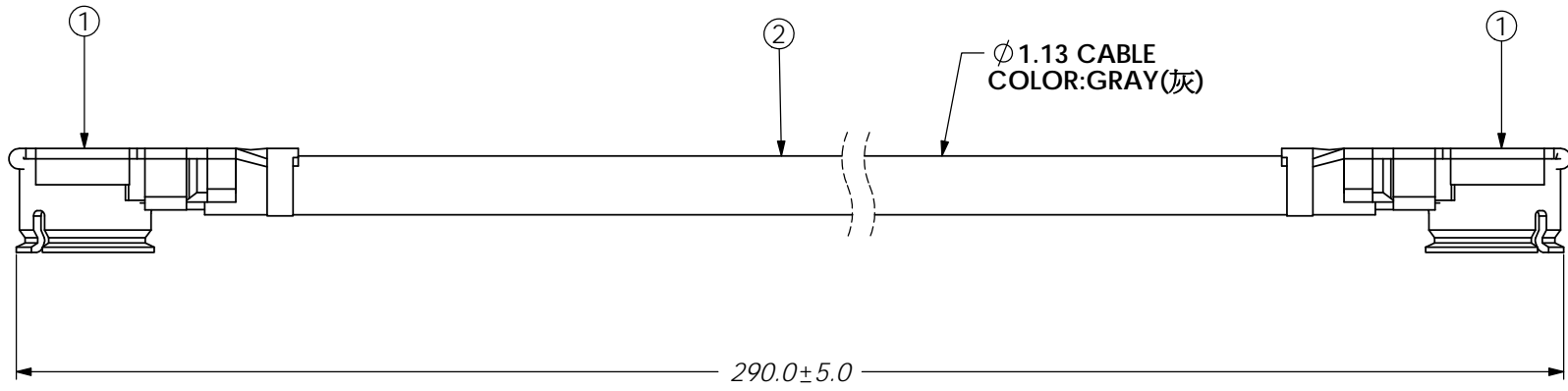
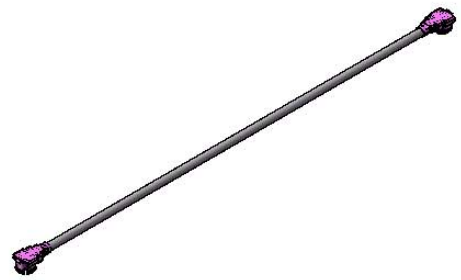

ELECTRICAL PERFORMANCE :

- 1.Impedance : 50 ohms
- 2.Frequency Range : DC~ 3 GHz
- 3.Working Voltage : AC60V Maximum
- 4.Dielectric Withstanding Voltage : AC200V Maximum
- 5.VSWR: DC ~ 3 GHz 1.3max.
3 ~ 6 GHz 1.5max.

2	$\phi 1.13$ CABLE	$\phi 1.13$ CABLE	GRAY	1
1	IPEX Connector	20278-112R-13	GOLD	2
ITEM	DESCRIPTION	PART NUMBER	FINISHED	Q'TY

RoHS
COMPLIANT
2002/95/EC

UNLESS OTHERWISE SPECIFIED ALL TOLERANCES ARE :			
DIMENSION		ANGLE	
INTEGRAL DIMENSIONS	± 1.0	ANGULAR DIMENSIONS	$\pm 5.0^\circ$
1 PLACE DECIMAL	± 0.5	HOLES UNDER $\phi 0.5$	± 0.1
2 PLACE DECIMALS	± 0.25	ROUGHNESS	
	FINISH: SEE TABLE	MATERIAL: SEE TABLE	



DRAWN BY:	TINA	DATE:	12-23'2010
ENGR BY:	TINA	DATE:	12-23'2010
APVD BY:		DATE:	

TITLE: IPEX TO IPEX FOR $\phi 1.13$ CABLE 29.0CM				
Model NO:		IPEXIPEX113A-0290C		
Drawing NO:		IPEXIPEX113A-0290C		
UNIT:	MM	SIZE:	A4	REV. B
SCALE:	7 : 1	SHEET	1 OF 1	CAD FILE: Z:NEW Dwg/CABLE/IPEX