

RECOMMENDED PCB LAYOUT
COMPONENT SIDE
TOLERANCE: ±0.05mm

NOTES:

1. MATERIAL:

- 1.1 INSULATOR: PA9T(GN2330), UL94V-0, COLOR: BLACK.
- 1.2 CONTACTS: BRASS(C2680),
- 1.3 PEG: BRASS(C2680).

2. FINISH:

- 2.1 CONTACTS: 80μ" MIN. TIN PLATED ENTIRE, 80μ" MIN. NICKEL UNDERPLATED.
- 2.2 PEG: 80μ" MIN. TIN PLATED ENTIRE, 80μ" MIN. NICKEL UNDERPLATED.

3. SPECIFICATIONS:

- 3.1 CURRENT RATING: 5A.
- 3.2 CONTACT RESISTANCE: 20mΩ MAX.
- 3.3 INSULATION RESISTANCE: 1000MΩ MIN.
- 3.4 DIELECTRIC WITHSTANDING VOLTAGE: AC1500V/MINUTE.
- 3.5 OPERATING TEMPERATURE: -40°C TO +105°C

4. OTHERS:

- 4.1 THIS COMPONENT AND ITS HOMOGENEOUS SUB COMPONENTS ARE RoHS COMPLIANT.
- 4.2 RESISTANCE TO SOLDERING HEAT 265°C FOR 5 SECONDS. (NOT INCLUDING THE PLASTIC POST)

TRAY	ACNPR210009-001
PACKING	CPC P/N.

REV.	DESCRIPTION	ECN NO.	NAME	DATE	DIM.	TOL.
A1	MODIFY VIEW	N1509006	Rock	14-Sep-2015	X.	± -
A0	FIRST RELEASED	-	Rock	31-Jul-2015	X.X	± 0.35
					X.XX	± 0.25
					X.XXX	± 0.15
					ANGL	± 3°

REVISIONS

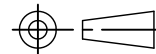

TITLE: POWER CONN 4P PITCH 5.08mm R/A DIP REC H10.3mm			
DWG. NO.: = ACNPR210009			
UNIT: mm	DWG SIZE: A4	SCALE: none	SHEET: 1 OF 1

DRAWN: Rock	
CHECKED: Vic	
APPROVED: Peter	
RFQ NO.:	Q1505077