

- 1.MATERIAL:  
 1.1 INSULATOR: PA9T, UL94V-0;  
 INSULATOR COLOR: BLACK.  
 1.2 CONTACT: BRASS.  
 1.3 PIN: BRASS.  
 1.4 SHELL: BRASS.  
 1.5 COVER: SUS301.  
 1.6 SPRING PIECE: SUS301.  
 1.7 STOPPER: SUS301.
- 2.FINISH:  
 2.1 CONTACT: TIN PLATED OVER.  
 NICKEL UNDERPLATED OVERALL.  
 2.2 SHELL: NICKEL PLATED OVERALL.  
 2.2 SPRING PIECE: TIN PLATED OVER.  
 NICKEL UNDERPLATED OVERALL.  
 2.3 PIN: NICKEL PLATED OVERALL.
- 3.CHARACTERISTIC REQUIREMENTS:  
 3.1 VOLTAGE RATING: DC 12V.  
 3.2 CURRENT RATING: 7 A.  
 3.3 CONTACT RESISTANCE: 50mΩ MAX.  
 3.4 INSULATION RESISTANCE: 100mΩ MIN DC 500V.  
 3.5 DIELECTRIC WITHSTANDING VOLTAGE: AC 500V PER MINUTE.  
 3.6 OPERATING TEMPERATURE: -40°C ~ +85°C.  
 3.7 MATING FORCE: 3.0 kg/f MAX.  
 3.8 UNMATING FORCE: 0.3 kg/f MIN.  
 3.9 DURABILITY LIFE CYCLE: 10000 TIMES.
- 4.NOTES:  
 4.1 THIS COMPONENT AND ITS HOMOGENEOUS  
 SUBCOMPONENTS ARE RoHS COMPLIANT.  
 4.2 RESISTANCE TO SOLDERING HEAT: 265°C FOR 5 SECONDS,  
 AND ONLY FOR WAVE SOLDERING.

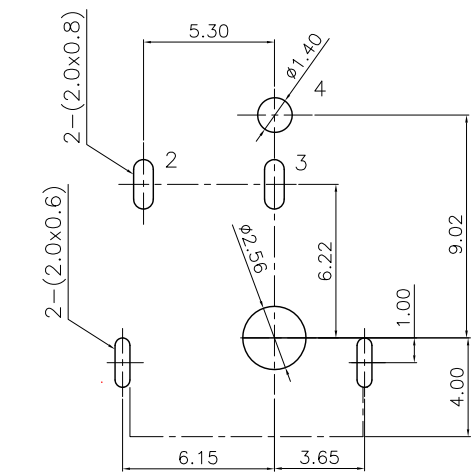

RECOMMENDED P.C.B LAYOUT(PCB THICKNESS: 1.6mm)  
 COMPONENT SIDE VIEW(TOLERANCE: ±0.05)

REV.	DESCRIPTION	ECN NO.	NAME	DATE
A1	MODIF SCHEMATIC	N1411014	Milo	Dec.11.2014
A0	NEW RELEASE		Allan	May.21.2013

REVISIONS

DIM.	TOL.
X	
X.X	±0.30
X.XX	±0.25
X.XXX	±0.15
GENERAL ANGLE: ±3°	

TITLE: DC POWER JACK 3PINS OD Ø2.50mm R/A DIP TYPE					
DWG. NO.: C-JP37FB2T-03E			DRAWN: Milo		
PART NO.: JP37FB2T-03E			CHECKED: Jessie		
UNIT: mm	SCALE: none	SHEET: 1 OF 1	DWG. SIZE: A4	LAYER: CA131	APPROVED: Peter

